

Official current version only in LEAR T&C DB.
 Official aktuelle Ausgabe nur in LEAR T&C DB.
 In gedruckter Form kein Änderungsstatus.
 In printed form no update information service.
 Catia V5 DIN A2

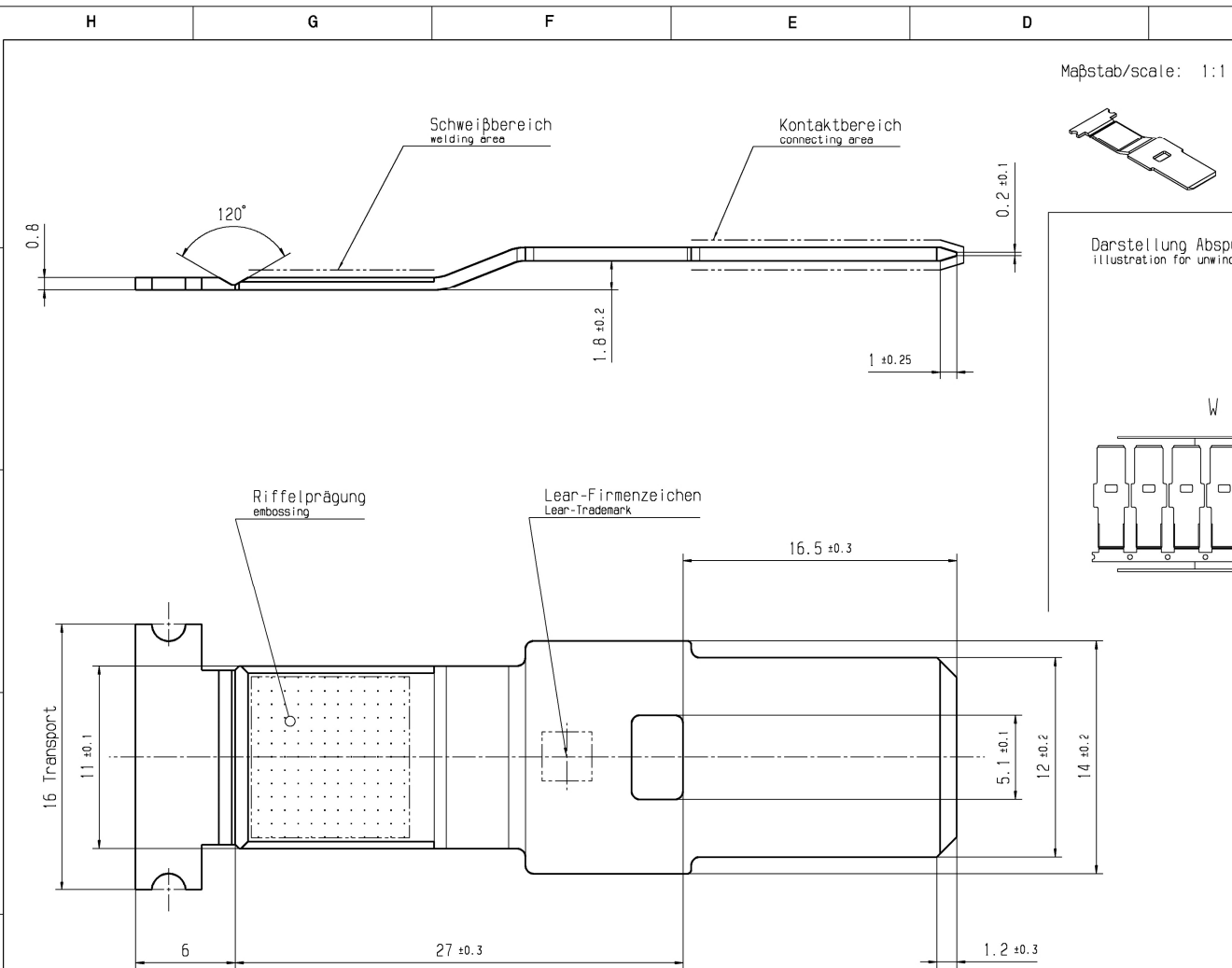

Maßstab/scale: 1:1

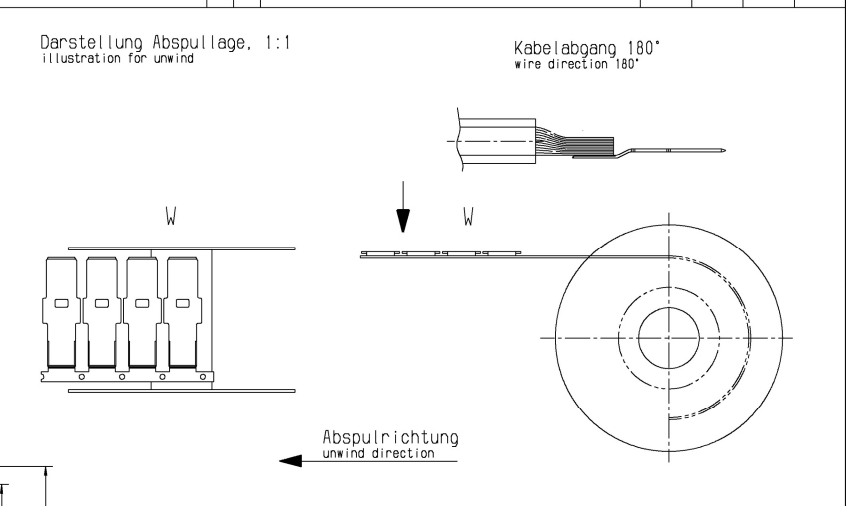
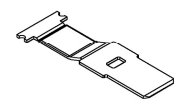

REV.	ZONE	DESCRIPTION	CS/REL. NO.	DATE	DESIGNED	CHECKED
1		first release		2014/09/19	Ce	KL
2		Lear T&C change report number 30490		2017/01/10	Weg	KL
3		Surface for 2879500005 corrected in connecting area Ag3		2022/09/07	Weg	KL
4		Surface for 2879500005 corrected in welding area Ag3-0.08		2023/03/08	Weg	KL

Version	Wire cross-section mm ²	SEM	T&C	Lear Part Number	weight (g)	Material	Surface	Remark
for 180° -application	4 - 35	a) E10711800	a) 28795 000 005				connecting area Ag3 welding area 0.03 - 0.08 Ag	ODT passiviert ODT passivated
for 180° -application		a) E03107600	a) 28795 000 004				connecting area Sn3 welding area blank/unplated	
for 180° -application		a) E03107500	a) 28795 000 003	3.51	CuCrTiSi		connecting area Ag3 welding area 0.03 - 0.08 Ag	
for 180° -application		E03107400	28795 000 002				connecting area Sn3 welding area blank/unplated	
for 180° -application		E02955300	28795 000 001				connecting area Ag3 welding area 0.03 - 0.08 Ag	

Bemerkungen / Comments

a) gereinigte Flachstecker (siehe Tabelle).
 Reinigung der Flachstecker nach Lear-WN 97000 000 003.
 cleaned terminals (see table).
 cleaning-process of the terminals acc. to Lear-WN 97000 000 003.

Verarbeitungsspezifikation Ultraschallschweißen
 nach Lear-WN 98313 300 063.
 application specification ultra-sonic-welding
 acc. to Lear-WN 98313 300 063.

ZULAESSIGE LAGERBEDINGUNGEN FUER LEAR T&C-PRODUKTE GEMAESS V/8023/06/R
 PERMISSIBLE STORAGE CONDITIONS FOR LEAR T&C-PRODUCTS IN ACCORDANCE TO...

GENERAL TOLERANCES - DIN 16901 - ISO 2768 - M	THE ENGLISH TRANSLATION IS BELIEVED TO BE ACCURATE. IN CASE OF DISCREPANCIES THE GERMAN VERSION SHALL GOVERN.	T&C Drawing Number 28795
ANGLE PROJECTION EU	MATERIAL: see table FINISH / SURFACE: see table COLOR: ---	WEIGHT CAD: see table VOLUME CAD: --- [g] [mm ³]
SCALE: 5:1	START DATE: 2014/09/18	Lear Corporation GmbH Schlosserstraße 4 42899 Remscheid Germany
DRAWN: Ce	TITLE miscellaneous / cross carline MAS 12 (11mm Schweißbreite ; 14mm Max.breite) CU-Anwendung	
DRW FILE NAME: 28795-...CG-D_00104	CAD DIRECTORY / CAD LOCATION: K-AUTOMOT/LAGER-28	MODEL FILE NAME: 28795-...P_00101
LAST UPDATE 2023/03/08	SEM DOCUMENT ID / DRAWING NUMBER D00449513 - 4	REVISION 1 1 CG
CONFIDENTIAL - THIS DRAWING AND ALL INFORMATION DISCLOSED HEREIN ARE OWNED BY LEAR CORPORATION AND ARE NOT TO BE DISTRIBUTED OR DISSEMINATED IN ANY MANNER UNLESS EXPRESSLY AUTHORIZED IN WRITING BY LEAR CORPORATION.		